

SCHEDULE "A"

PROPOSED SUBDIVISION

CHARANJIT KANDOLA

LOT 56, DISTRICT LOT 23-G,
WELLINGTON DISTRICT,
PLAN 15154

ADDRESS : 5865 TURNER ROAD,
NANAIMO, B.C.

PROJECT SURVEYOR : D.G. WALLACE

DRAWN BY : DAW DATE : FEB 26, 2018

OUR FILE : 89145 REVISION :



J.E. ANDERSON
& ASSOCIATES
SURVEYORS - ENGINEERS

1A - 3411 SHENTON ROAD, NANAIMO, B.C. V8T 2H1
TEL: 250 - 758 - 4631 FAX: 250 - 758 - 4660
E-MAIL : nanaimo@jeanderson.com
NANAIMO - VICTORIA - PARKSVILLE - CAMPBELL RIVER

LEGEND

ALL DIMENSIONS ARE IN METRES

SUBJECT TO CHARGES SHOWN
ON TITLE NO. CA6299450
(P.I.D. 004-186-095)

DIMENSIONS ARE DERIVED FROM
LAND TITLE OFFICE RECORDS

THIS PLAN HAS BEEN PREPARED IN
ACCORDANCE WITH THE PROFESSIONAL
REFERENCE MANUAL

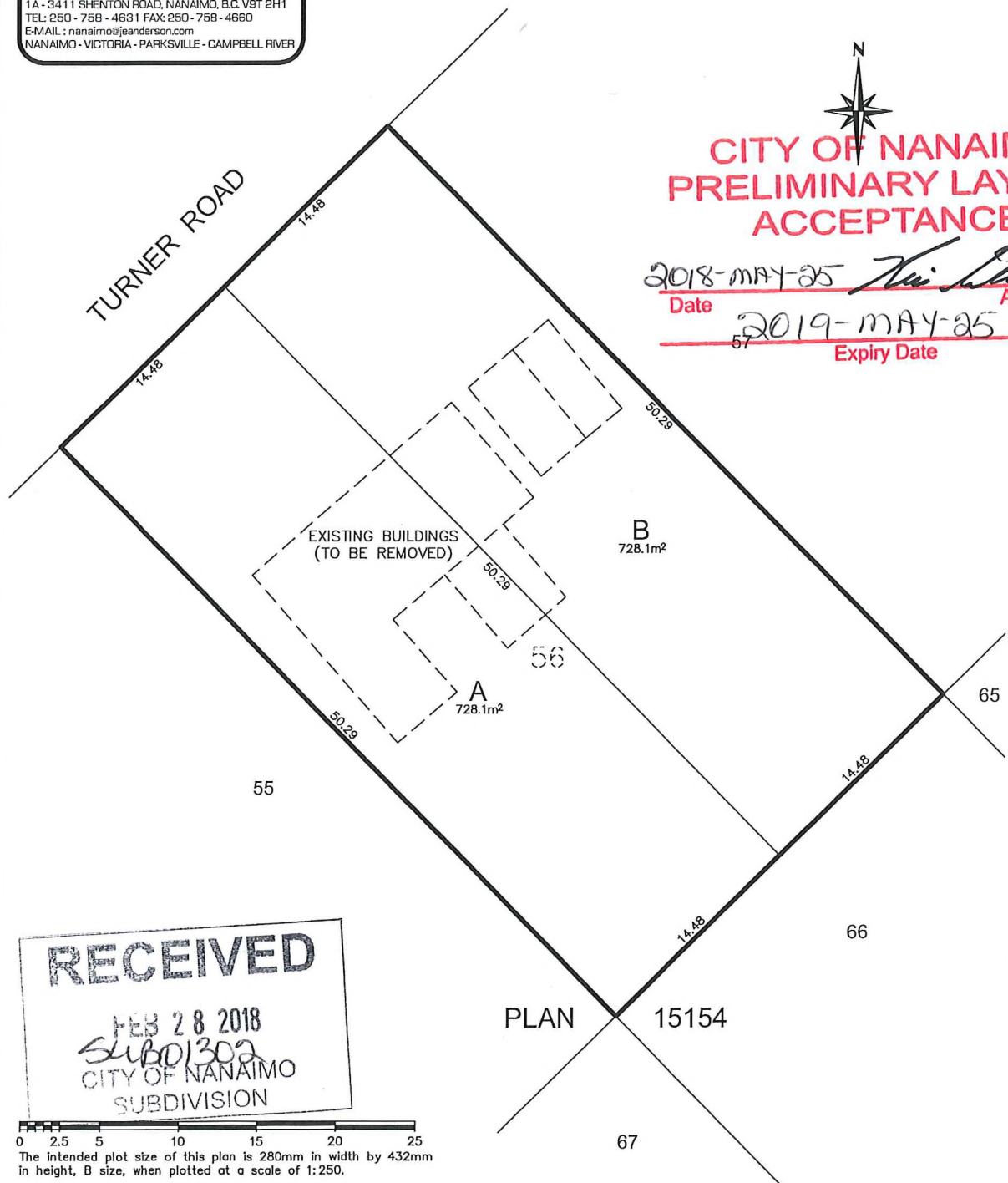

CITY OF NANAIMO
PRELIMINARY LAYOUT
ACCEPTANCE

2018-MAY-25 *[Signature]*
 Date Approved By
 2019-MAY-25
 57 Expiry Date

RECEIVED
 FEB 28 2018
 SUB 01302
 CITY OF NANAIMO
 SUBDIVISION

0 2.5 5 10 15 20 25
 The intended plot size of this plan is 280mm in width by 432mm
 in height, B size, when plotted at a scale of 1:250.

PLAN 15154